

FLOOR LAYOUT PLAN
SCALE 1:50

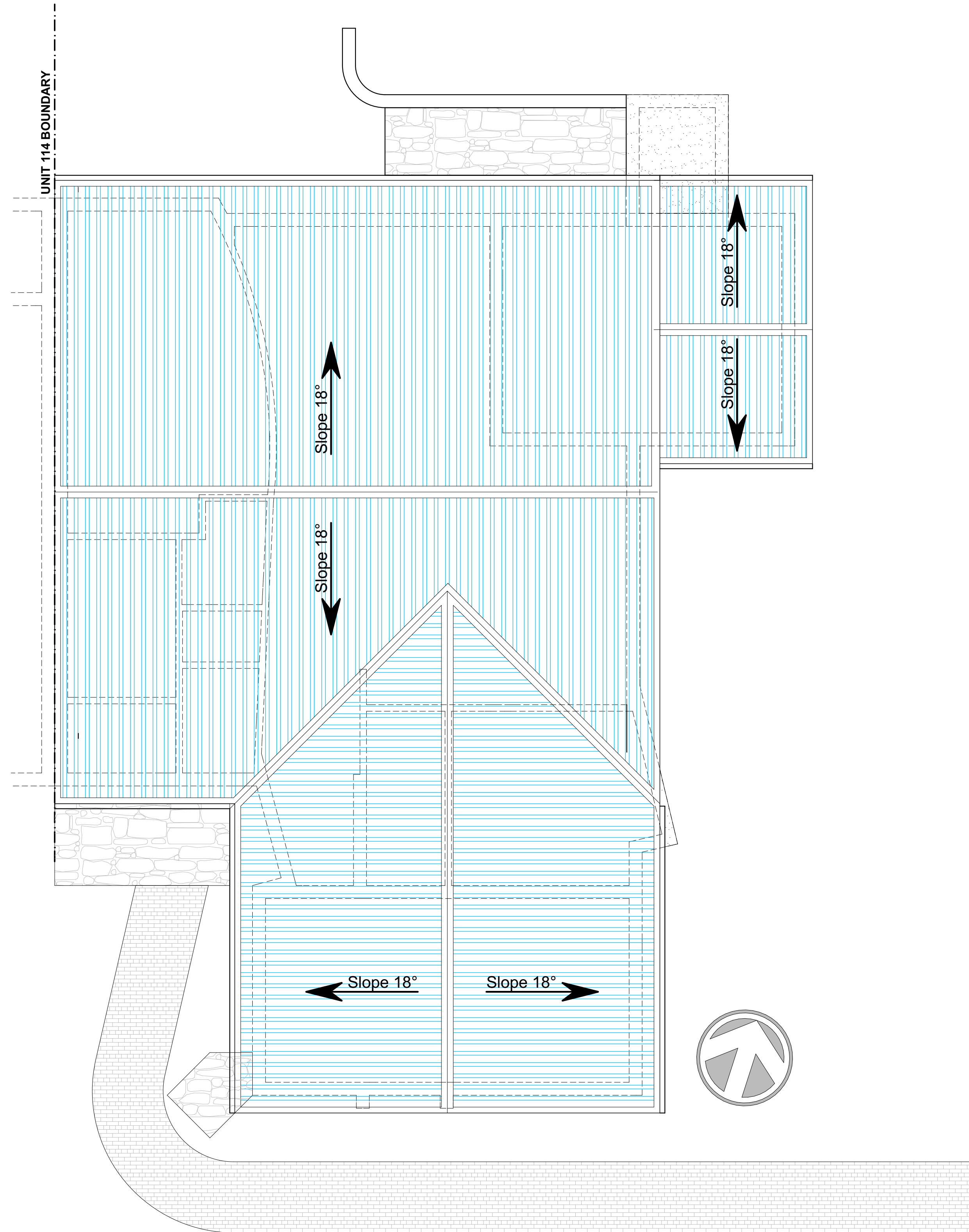

ROOF LAYOUT PLAN
SCALE 1:50

- NOTES:**
- All dimensions & levels to be verified on site.
 - All minimum datum levels of 170mm above NGL to be adhered to at all times or otherwise specified on the Architect's drawings.
 - All building materials to be fitted in accordance with manufacturer's specification's, SABS standards & in accordance with the National building regulation's.
 - All Architect's drawings to be read in conjunction with Engineer's drawings if applicable.
 - Any discrepancies to be reported to the Architect immediately
 - Drawings may not be scaled. Figured dimensions may only be used
 - This drawing is the copyright and property of Axel Dainat Architects and must not be retained, copied or used without authority

COPYRIGHT © RESERVED ©

AREA CALCULATION - UNIT 108

- ERF portion 47 of the farm onderkaremba no. 78 = 77720m²
- Main Bedroom = 16.56m²
- en Suite WC = 7.25m²
- Bedroom 01 = 19.25m²
- Guest WC = 3.44m²
- Pantry = 2.19m²
- Entrance = 5.34m²
- Living Area = 39.88m²
- Kitchen = 9.47m²
- Patio = 7.31m²
- Veranda = 17.17m²
- Store Room = 3.97m²
- Total Useable Area = 140.47m²**
- Building Footprint = 153.31m²**

MUNICIPAL SUBMISSION ONLY

CLIENT
LIGHT PROPERTIES
P.O. BOX 90859
KLEIN WINDHOEK
Tel: +264 (0)67 677 018
Fax: +264 (0)67 687 020
e-mail: info@waterber-wildernes.com

ARCHITECT
axel Dainat
architects
P.O. BOX 25005 WINDHOEK NAMIBIA
TEL. +264 (061) 237860
FAX. +264 (061) 237878
EMAIL: barbara@adarchitects.com.na

QUANTITY SURVEYOR

CONSULTANT

CONSULTANT

PROJECT TITLE:
COMPLIANCE FOR SONNLEITEN
RETIREMENT VILLAGE - PORTION 47
OF THE FARM ONDERKAREMBA
NO.78 **UNIT 115**

**FLOOR LAYOUT
ROOF LAYOUT**

DATE: Monday, April 11, 2016	DRAWN: B.THIEM	
SCALE: AS SHOWN	CHECKED:	
PROJECT NO: W 698	DWG NO:	REV: